

# imageRUNNER ADVANCE DX C5800 Series

## POWERFUL PRODUCTIVITY FROM SECURE COLOUR A3 MULTIFUNCTION DEVICES



Canon uniFLOW Online  
Outstanding Cloud Output Management Solution



Canon uniFLOW Online  
Outstanding Cloud Output Management Solution



New to the Line

### MAIN CONFIGURATION OPTIONS

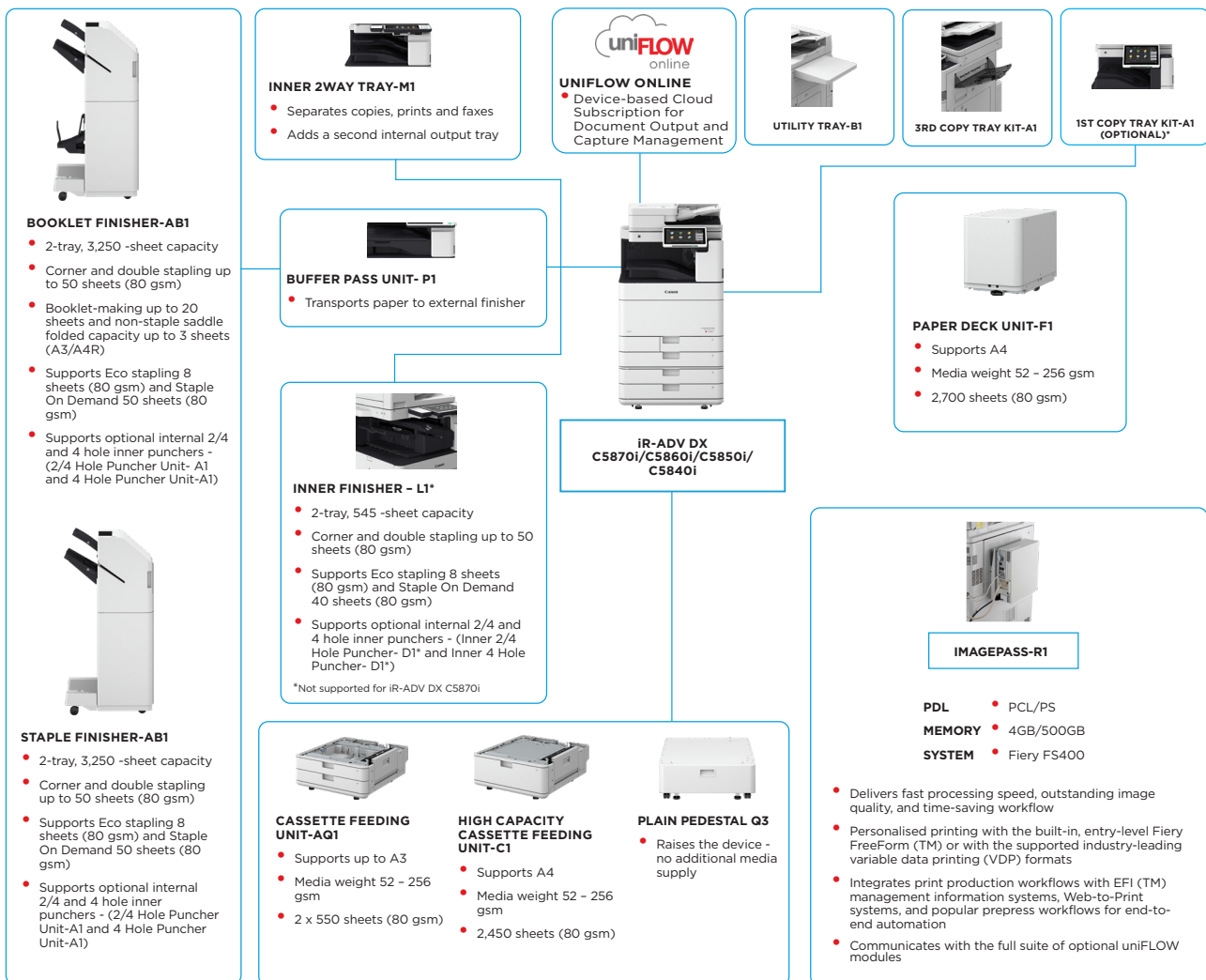

This flat configuration is for illustration purpose only. For a complete list of options and the exact compatibility relationships, please refer to the [online product configurator](#).

The Unified Firmware Platform (UFP) ensures that the latest feature upgrades and protection are available, for an enhanced user experience across the entire iR ADVANCE DX portfolio.

\*To support Sustainability and save on raw materials required for plastics, 1st Copy Tray Kit-A1 is optional.

# TECHNICAL SPECIFICATIONS

# imageRUNNER ADVANCE DX C5800 Series

<b>MAIN UNIT</b>	A3 Color Laser Multifunctional	<b>Fonts</b>	PS fonts: 136 Roman PCL fonts: 93 Roman, 10 Bitmap fonts, 2 OCR fonts, Andalé Mono WT J/K/S/T <sup>†1</sup> (Japanese, Korean, Simplified and Traditional Chinese), Barcode fonts <sup>†2</sup> <sup>†1</sup> Optional PCL International Font Set-A1 is required. <sup>†2</sup> Optional Barcode Printing Kit-D1 is required.
<b>Machine type</b>	Print, Copy, Scan, Send, Store and Optional Fax	<b>Print Features</b>	Secured Print, Secure Watermark, Header/Footer, Page Layout, Two-sided Printing, Mixed Paper Sizes/Orientations, Front/Back Covers, Toner Reduction, Poster Printing, Forced Hold printing, Print Date, Scheduled Printing, Printing Using a Virtual Printer
<b>Core functions</b>	1.8GHz Dual Core Processor	<b>Operating System</b>	UFRIL: Windows® 8.1/10/Server2012/Server2012 R2/Server2016/Server2019, Mac OS X(10.11 or later) PCL: Windows® 8.1/10/Server2012/Server2012 R2/Server2016/Server2019 PS: 8.1/10/Server2012/Server2012 R2/Server2016/Server2019 PPD: Windows® 8.1/10, Mac OS X(10.10 or later) McAfee Embedded Control Software As of Oct. 2020
<b>Processor</b>	10.1" TFT LCD WSVGA Color Touch panel (up to 90° tiltable)	<b>COPY SPECIFICATIONS</b>	
<b>Control Panel</b>	Standard: 5.0GB RAM Standard: (SSD) 256GB, Optional: (SSD) 256GB, 1TB	<b>Copy Speed (BW &amp; CL)</b>	iR-ADV DX C5870i up to 70 ppm (A4, A5*, A5R, A6R), up to 36 ppm (A3), up to 42 ppm (A4R)
<b>Memory</b>	NETWORK Standard: 1000Base-T/100Base-TX/10Base-T, Wireless LAN (IEEE 802.11 b/g/n); Optional: NFC, Bluetooth Low Energy	<b>*1 sided only</b>	iR-ADV DX C5860i up to 60 ppm (A4, A5*, A5R, A6R), up to 32 ppm (A3), up to 36 ppm (A4R)
<b>Storage</b>	OTHERS Standard: USB 2.0 (Host) x1, USB 3.0 (Host) x1, USB 2.0 (Device) x1; Optional: Serial Interface, Copy Control Interface		iR-ADV DX C5850i up to 50 ppm (A4, A5*, A5R, A6R), up to 27 ppm (A3), up to 30 ppm (A4R)
<b>Interface Connection</b>	Standard: 1,200 sheets 100-sheet Multi-purpose tray x 1 550-sheet Paper cassette x 2 Maximum: 6,350 sheets (with High Capacity Cassette Feeding Unit-C1 + Paper Deck Unit-F1)		iR-ADV DX C5840i up to 40 ppm (A4, A5*, A5R, A6R), up to 21 ppm (A3), up to 24 ppm (A4R)
<b>Paper Supply Capacity (A4, 80gsm)</b>	Maximum: 3,450 Sheets (with Staple Finisher-AB1 or Booklet Finisher-AB1 and 3rd Copy Tray Kit-A1)	<b>First-Copy-Out Time (A4, BW/CL)</b>	iR-ADV DX C5870i: Approx. 2.7 / 3.7 seconds or less iR-ADV DX C5860i: Approx. 2.9 / 4.2 seconds or less iR-ADV DX C5850i: Approx. 3.4 / 4.9 seconds or less iR-ADV DX C5840i: Approx. 4.1 / 6.1 seconds or less
<b>Paper output capacity (A4, 80gsm)</b>	Collate, Group, Offset, Staple, Saddle Stitch, Hole Punch, Eco Staple, Staple On Demand <sup>*</sup> Finishing capabilities will vary depending on the options connected.	<b>Copy resolution (dpi)</b>	600 x 600
<b>Finishing capabilities</b>	Multi-purpose tray: Thin, Plain, Recycled, Color, Heavy, Coated, Tracing, Bond, Transparency, Label, Pre-punched, Letterhead, Tab, Envelope	<b>Multiple Copies</b>	Up to 999 copies
<b>Supported Media Types</b>	Paper Cassette (Upper/Lower): Thin, Plain, Recycled, Color, Heavy, Bond, Transparency, Pre-punched, Letterhead, Envelope <sup>*</sup> <sup>*</sup> Envelope Feeder Attachment (standard) is required.	<b>Copy Density</b>	Automatic or Manual (9 Levels)
<b>Supported Media Sizes</b>	Multi-purpose tray: Standard size: SRA3, A3, A4, A4R, A5, A5R, A6R, B4, B5, B5R Custom size: 98.0 x 139.7 mm to 320.0 x 457.2 mm Free Size: 98.0 x 139.7 mm to 320.0 x 457.2 mm Envelopes: COM10 No.10, Monarch, DL, ISO-C5 Envelope custom size: 98.0 x 90.0 mm to 320.0 x 457.2 mm	<b>Magnification</b>	Variable zoom: 25% to 400% (1% Increments) Preset reduction/enlargement: 25%, 50%, 70%, 100%(1:1), 141%, 200%, 400%
<b>Supported Media Weights</b>	Upper Cassette: Standard size: A4, A5, A5R, A6R, B5 Custom Size: 98.0 x 148.0 mm to 304.8 x 457.2 mm Envelopes: COM10 No.10, Monarch, DL, ISO-C5	<b>Copy Features</b>	Preset R/E Ratios by Area, Two-Sided, Density Adjustment, Original Type Selection, Interrupt Mode, Book to Two Pages, Two-sided Original, Job Build, N on 1, Add Cover, Insert Sheets, Different Size Originals, Page Numbering, Copy Set Numbering, Sharpness, Erase Frame, Secure Watermark, Print Date, Gutter, Print & Check, Negative/Positive, Repeat Images, Merge Job Blocks, Mirror Image, Store in Mail Box, Superimpose Image, Copy ID Card, Skip Blank Pages, Free Size Original, Color Mode, Reserved Copy, Copy Sample
<b>Supported media weights</b>	Lower Cassette: Standard size: A3, A4, A4R, A5, A5R, A6R, B4, B5, B5R Custom size: 98.0 x 148.0 mm to 304.8 x 457.2 mm Envelopes: COM10 No.10, Monarch, DL, ISO-C5	<b>Copy Resolution (dpi)</b>	Up to 999 copies
<b>Warm-up Time</b>	Multi-purpose tray: 52 to 300 gsm Paper Cassette (Upper/Lower): 52 to 256 gsm Duplex: 52 to 256 gsm	<b>Multiple Copies</b>	Automatic or Manual (9 Levels)
<b>Warm-up Time</b>	Quick Startup Mode: 4 Seconds or less <sup>*</sup> <sup>*</sup> Time from device power-on to when the copy icon appears and is enabled to operate on the touch panel display.	<b>Magnification</b>	Variable zoom: 25% to 400% (1% Increments) Preset reduction/enlargement: 25%, 50%, 70%, 100%(1:1), 141%, 200%, 400%
<b>Warm-up Time</b>	From Sleep Mode: 7 Seconds or Less (iR-ADV DX C5870i) 6 Seconds or Less (iR-ADV DX C5860i/C5850i/C5840i)	<b>Copy Features</b>	Preset R/E Ratios by Area, Two-Sided, Density Adjustment, Original Type Selection, Interrupt Mode, Book to Two Pages, Two-sided Original, Job Build, N on 1, Add Cover, Insert Sheets, Different Size Originals, Page Numbering, Copy Set Numbering, Sharpness, Erase Frame, Secure Watermark, Print Date, Gutter, Print & Check, Negative/Positive, Repeat Images, Merge Job Blocks, Mirror Image, Store in Mail Box, Superimpose Image, Copy ID Card, Skip Blank Pages, Free Size Original, Color Mode, Reserved Copy, Copy Sample
<b>Warm-up Time</b>	From Power On: 6 Seconds or less (with Quick Start Mode) <sup>*</sup> <sup>*</sup> Time from device power-on, until copy ready (not print reservation).	<b>Copy Resolution (dpi)</b>	Up to 999 copies
<b>Dimensions (W x D x H)</b>	iR-ADV DX C5870i/C5860i/C5850i/C5840i: 620 x 722 x 937 mm	<b>Multiple Copies</b>	Automatic or Manual (9 Levels)
<b>Installation Space (W x D)</b>	iR-ADV DX C5870i/C5860i/C5850i/C5840i: Basic: 1,138 x 1,162 mm (Right Cover Open with Multi-purpose tray extended + Cassette Drawers Open) Fully Configured: 1,866 x 1,162 mm (Staple Finisher-AB1/Booklet Finisher-AB1 with the extension tray extended + Paper Deck Unit-F1 + Cassette Drawers open)	<b>Magnification</b>	Variable zoom: 25% to 400% (1% Increments) Preset reduction/enlargement: 25%, 50%, 70%, 100%(1:1), 141%, 200%, 400%
<b>Weight</b>	iR-ADV DX C5870i: Approx. 108 kg including regular toner iR-ADV DX C5860i/C5850i: Approx. 105 kg including regular toner iR-ADV DX C5840i: Approx. 104 kg including regular toner	<b>Copy Features</b>	Preset R/E Ratios by Area, Two-Sided, Density Adjustment, Original Type Selection, Interrupt Mode, Book to Two Pages, Two-sided Original, Job Build, N on 1, Add Cover, Insert Sheets, Different Size Originals, Page Numbering, Copy Set Numbering, Sharpness, Erase Frame, Secure Watermark, Print Date, Gutter, Print & Check, Negative/Positive, Repeat Images, Merge Job Blocks, Mirror Image, Store in Mail Box, Superimpose Image, Copy ID Card, Skip Blank Pages, Free Size Original, Color Mode, Reserved Copy, Copy Sample
<b>PRINT SPECIFICATIONS</b>		<b>Copy Resolution (dpi)</b>	Up to 999 copies
<b>Print Speed (BW/CL)</b>		<b>Multiple Copies</b>	Automatic or Manual (9 Levels)
<b>*1 sided only</b>		<b>Magnification</b>	Variable zoom: 25% to 400% (1% Increments) Preset reduction/enlargement: 25%, 50%, 70%, 100%(1:1), 141%, 200%, 400%
	iR-ADV DX C5870i up to 70 ppm (A4, A5*, A5R, A6R), up to 36 ppm (A3), up to 42 ppm (A4R)	<b>Copy Features</b>	Preset R/E Ratios by Area, Two-Sided, Density Adjustment, Original Type Selection, Interrupt Mode, Book to Two Pages, Two-sided Original, Job Build, N on 1, Add Cover, Insert Sheets, Different Size Originals, Page Numbering, Copy Set Numbering, Sharpness, Erase Frame, Secure Watermark, Print Date, Gutter, Print & Check, Negative/Positive, Repeat Images, Merge Job Blocks, Mirror Image, Store in Mail Box, Superimpose Image, Copy ID Card, Skip Blank Pages, Free Size Original, Color Mode, Reserved Copy, Copy Sample
	iR-ADV DX C5860i up to 60 ppm (A4, A5*, A5R, A6R), up to 32 ppm (A3), up to 36 ppm (A4R)	<b>Copy Resolution (dpi)</b>	Up to 999 copies
	iR-ADV DX C5850i up to 50 ppm (A4, A5*, A5R, A6R), up to 27 ppm (A3), up to 30 ppm (A4R)	<b>Multiple Copies</b>	Automatic or Manual (9 Levels)
	iR-ADV DX C5840i up to 40 ppm (A4, A5*, A5R, A6R), up to 21 ppm (A3), up to 24 ppm (A4R)	<b>Magnification</b>	Variable zoom: 25% to 400% (1% Increments) Preset reduction/enlargement: 25%, 50%, 70%, 100%(1:1), 141%, 200%, 400%
<b>Print Resolution (dpi)</b>	1,200 x 1,200	<b>Copy Features</b>	Preset R/E Ratios by Area, Two-Sided, Density Adjustment, Original Type Selection, Interrupt Mode, Book to Two Pages, Two-sided Original, Job Build, N on 1, Add Cover, Insert Sheets, Different Size Originals, Page Numbering, Copy Set Numbering, Sharpness, Erase Frame, Secure Watermark, Print Date, Gutter, Print & Check, Negative/Positive, Repeat Images, Merge Job Blocks, Mirror Image, Store in Mail Box, Superimpose Image, Copy ID Card, Skip Blank Pages, Free Size Original, Color Mode, Reserved Copy, Copy Sample
<b>Page description languages</b>	Standard: UFR II, PCL6, Adobe® PostScript®3™	<b>Copy Resolution (dpi)</b>	Up to 999 copies
<b>Direct Print</b>	Supported file types: PDF, EPS, TIFF/JPEG, and XPS AirPrint, Mopria, Universal Print by Microsoft	<b>Multiple Copies</b>	Automatic or Manual (9 Levels)
<b>Printing from mobile and cloud</b>	Canon PRINT Business and uniFLOW Online (optional) A range of software and MEAP-based solutions are available to provide printing from mobile devices or internet-connected devices and cloud-based services depending on your requirements. Please contact your sales representative for further information.	<b>Magnification</b>	Variable zoom: 25% to 400% (1% Increments) Preset reduction/enlargement: 25%, 50%, 70%, 100%(1:1), 141%, 200%, 400%
		<b>Copy Features</b>	Preset R/E Ratios by Area, Two-Sided, Density Adjustment, Original Type Selection, Interrupt Mode, Book to Two Pages, Two-sided Original, Job Build, N on 1, Add Cover, Insert Sheets, Different Size Originals, Page Numbering, Copy Set Numbering, Sharpness, Erase Frame, Secure Watermark, Print Date, Gutter, Print & Check, Negative/Positive, Repeat Images, Merge Job Blocks, Mirror Image, Store in Mail Box, Superimpose Image, Copy ID Card, Skip Blank Pages, Free Size Original, Color Mode, Reserved Copy, Copy Sample
		<b>Copy Resolution (dpi)</b>	Up to 999 copies
		<b>Multiple Copies</b>	Automatic or Manual (9 Levels)
		<b>Magnification</b>	Variable zoom: 25% to 400% (1% Increments) Preset reduction/enlargement: 25%, 50%, 70%, 100%(1:1), 141%, 200%, 400%
		<b>Copy Features</b>	Preset R/E Ratios by Area, Two-Sided, Density Adjustment, Original Type Selection, Interrupt Mode, Book to Two Pages, Two-sided Original, Job Build, N on 1, Add Cover, Insert Sheets, Different Size Originals, Page Numbering, Copy Set Numbering, Sharpness, Erase Frame, Secure Watermark, Print Date, Gutter, Print & Check, Negative/Positive, Repeat Images, Merge Job Blocks, Mirror Image, Store in Mail Box, Superimpose Image, Copy ID Card, Skip Blank Pages, Free Size Original, Color Mode, Reserved Copy, Copy Sample
		<b>Copy Resolution (dpi)</b>	Up to 999 copies
		<b>Multiple Copies</b>	Automatic or Manual (9 Levels)
		<b>Magnification</b>	Variable zoom: 25% to 400% (1% Increments) Preset reduction/enlargement: 25%, 50%, 70%, 100%(1:1), 141%, 200%, 400%
		<b>Copy Features</b>	Preset R/E Ratios by Area, Two-Sided, Density Adjustment, Original Type Selection, Interrupt Mode, Book to Two Pages, Two-sided Original, Job Build, N on 1, Add Cover, Insert Sheets, Different Size Originals, Page Numbering, Copy Set Numbering, Sharpness, Erase Frame, Secure Watermark, Print Date, Gutter, Print & Check, Negative/Positive, Repeat Images, Merge Job Blocks, Mirror Image, Store in Mail Box, Superimpose Image, Copy ID Card, Skip Blank Pages, Free Size Original, Color Mode, Reserved Copy, Copy Sample
		<b>Copy Resolution (dpi)</b>	Up to 999 copies
		<b>Multiple Copies</b>	Automatic or Manual (9 Levels)
		<b>Magnification</b>	Variable zoom: 25% to 400% (1% Increments) Preset reduction/enlargement: 25%, 50%, 70%, 100%(1:1), 141%, 200%, 400%
		<b>Copy Features</b>	Preset R/E Ratios by Area, Two-Sided, Density Adjustment, Original Type Selection, Interrupt Mode, Book to Two Pages, Two-sided Original, Job Build, N on 1, Add Cover, Insert Sheets, Different Size Originals, Page Numbering, Copy Set Numbering, Sharpness, Erase Frame, Secure Watermark, Print Date, Gutter, Print & Check, Negative/Positive, Repeat Images, Merge Job Blocks, Mirror Image, Store in Mail Box, Superimpose Image, Copy ID Card, Skip Blank Pages, Free Size Original, Color Mode, Reserved Copy, Copy Sample
		<b>Copy Resolution (dpi)</b>	Up to 999 copies
		<b>Multiple Copies</b>	Automatic or Manual (9 Levels)
		<b>Magnification</b>	Variable zoom: 25% to 400% (1% Increments) Preset reduction/enlargement: 25%, 50%, 70%, 100%(1:1), 141%, 200%, 400%
		<b>Copy Features</b>	Preset R/E Ratios by Area, Two-Sided, Density Adjustment, Original Type Selection, Interrupt Mode, Book to Two Pages, Two-sided Original, Job Build, N on 1, Add Cover, Insert Sheets, Different Size Originals, Page Numbering, Copy Set Numbering, Sharpness, Erase Frame, Secure Watermark, Print Date, Gutter, Print & Check, Negative/Positive, Repeat Images, Merge Job Blocks, Mirror Image, Store in Mail Box, Superimpose Image, Copy ID Card, Skip Blank Pages, Free Size Original, Color Mode, Reserved Copy, Copy Sample
		<b>Copy Resolution (dpi)</b>	Up to 999 copies
		<b>Multiple Copies</b>	Automatic or Manual (9 Levels)
		<b>Magnification</b>	Variable zoom: 25% to 400% (1% Increments) Preset reduction/enlargement: 25%, 50%, 70%, 100%(1:1), 141%, 200%, 400%
		<b>Copy Features</b>	Preset R/E Ratios by Area, Two-Sided, Density Adjustment, Original Type Selection, Interrupt Mode, Book to Two Pages, Two-sided Original, Job Build, N on 1, Add Cover, Insert Sheets, Different Size Originals, Page Numbering, Copy Set Numbering, Sharpness, Erase Frame, Secure Watermark, Print Date, Gutter, Print & Check, Negative/Positive, Repeat Images, Merge Job Blocks, Mirror Image, Store in Mail Box, Superimpose Image, Copy ID Card, Skip Blank Pages, Free Size Original, Color Mode, Reserved Copy, Copy Sample
		<b>Copy Resolution (dpi)</b>	Up to 999 copies
		<b>Multiple Copies</b>	Automatic or Manual (9 Levels)
		<b>Magnification</b>	Variable zoom: 25% to 400% (1% Increments) Preset reduction/enlargement: 25%, 50%, 70%, 100%(1:1), 141%, 200%, 400%
		<b>Copy Features</b>	Preset R/E Ratios by Area, Two-Sided, Density Adjustment, Original Type Selection, Interrupt Mode, Book to Two Pages, Two-sided Original, Job Build, N on 1, Add Cover, Insert Sheets, Different Size Originals, Page Numbering, Copy Set Numbering, Sharpness, Erase Frame, Secure Watermark, Print Date, Gutter, Print & Check, Negative/Positive, Repeat Images, Merge Job Blocks, Mirror Image, Store in Mail Box, Superimpose Image, Copy ID Card, Skip Blank Pages, Free Size Original, Color Mode, Reserved Copy, Copy Sample
		<b>Copy Resolution (dpi)</b>	Up to 999 copies
		<b>Multiple Copies</b>	Automatic or Manual (9 Levels)
		<b>Magnification</b>	Variable zoom: 25% to 400% (1% Increments) Preset reduction/enlargement: 25%, 50%, 70%, 100%(1:1), 141%, 200%, 400%
		<b>Copy Features</b>	Preset R/E Ratios by Area, Two-Sided, Density Adjustment, Original Type Selection, Interrupt Mode, Book to Two Pages, Two-sided Original, Job Build, N on 1, Add Cover, Insert Sheets, Different Size Originals, Page Numbering, Copy Set Numbering, Sharpness, Erase Frame, Secure Watermark, Print Date, Gutter, Print & Check, Negative/Positive, Repeat Images, Merge Job Blocks, Mirror Image, Store in Mail Box, Superimpose Image, Copy ID Card, Skip Blank Pages, Free Size Original, Color Mode, Reserved Copy, Copy Sample
		<b>Copy Resolution (dpi)</b>	Up to 999 copies
		<b>Multiple Copies</b>	Automatic or Manual (9 Levels)
		<b>Magnification</b>	Variable zoom: 25% to 400% (1% Increments) Preset reduction/enlargement: 25%, 50%, 70%, 100%(1:1), 141%, 200%, 400%
		<b>Copy Features</b>	Preset R/E Ratios by Area, Two-Sided, Density Adjustment, Original Type Selection, Interrupt Mode, Book to Two Pages, Two-sided Original, Job Build, N on 1, Add Cover, Insert Sheets, Different Size Originals, Page Numbering, Copy Set Numbering, Sharpness, Erase Frame, Secure Watermark, Print Date, Gutter, Print & Check, Negative/Positive, Repeat Images, Merge Job Blocks, Mirror Image, Store in Mail Box, Superimpose Image, Copy ID Card, Skip Blank Pages, Free Size Original, Color Mode, Reserved Copy, Copy Sample
		<b>Copy Resolution (dpi)</b>	Up to 999 copies
		<b>Multiple Copies</b>	Automatic or Manual (9 Levels)
		<b>Magnification</b>	Variable zoom: 25% to 400% (1% Increments) Preset reduction/enlargement: 25%, 50%, 70%, 100%(1:1), 141%, 200%, 400%
		<b>Copy Features</b>	Preset R/E Ratios by Area, Two-Sided, Density Adjustment, Original Type Selection, Interrupt Mode, Book to Two Pages, Two-sided Original, Job Build, N on 1, Add Cover, Insert Sheets, Different Size Originals, Page Numbering, Copy Set Numbering, Sharpness, Erase Frame, Secure Watermark, Print Date, Gutter, Print & Check, Negative/Positive, Repeat Images, Merge Job Blocks, Mirror Image, Store in Mail Box, Superimpose Image, Copy ID Card, Skip Blank Pages, Free Size Original, Color Mode, Reserved Copy, Copy Sample
		<b>Copy Resolution (dpi)</b>	Up to 999 copies
		<b>Multiple Copies</b>	Automatic or Manual (9 Levels)
		<b>Magnification</b>	Variable zoom: 25% to 400% (1% Increments) Preset reduction/enlargement: 25%, 50%, 70%, 100%(1:1), 141%, 200%, 400%
		<b>Copy Features</b>	Preset R/E Ratios by Area, Two-Sided, Density Adjustment, Original Type Selection, Interrupt Mode, Book to Two Pages, Two-sided Original, Job Build, N on 1, Add Cover, Insert Sheets, Different Size Originals, Page Numbering, Copy Set Numbering, Sharpness, Erase Frame, Secure Watermark, Print Date, Gutter, Print & Check, Negative/Positive, Repeat Images, Merge Job Blocks, Mirror Image, Store in Mail Box, Superimpose Image, Copy ID Card, Skip Blank Pages, Free Size Original, Color Mode, Reserved Copy, Copy Sample
		<b>Copy Resolution (dpi)</b>	Up to 999 copies
		<b>Multiple Copies</b>	Automatic or Manual (9 Levels)
		<b>Magnification</b>	Variable zoom: 25% to 400% (1% Increments) Preset reduction/enlargement: 25%, 50%, 70%, 100%(1:1), 141%, 200%, 400%
		<b>Copy Features</b>	Preset R/E Ratios by Area, Two-Sided, Density Adjustment, Original Type Selection, Interrupt Mode, Book to Two Pages, Two-sided Original, Job Build, N on 1, Add Cover, Insert Sheets, Different Size Originals, Page Numbering, Copy Set Numbering, Sharpness, Erase Frame, Secure Watermark, Print Date, Gutter, Print & Check, Negative/Positive, Repeat Images, Merge Job Blocks, Mirror Image, Store in Mail Box, Superimpose Image, Copy ID Card, Skip Blank Pages, Free Size Original, Color Mode, Reserved Copy, Copy Sample
		<b>Copy Resolution (dpi)</b>	Up to 999 copies
		<b>Multiple Copies</b>	Automatic or Manual (9 Levels)
		<b>Magnification</b>	Variable zoom: 25% to 400% (1% Increments) Preset reduction/enlargement: 25%, 50%, 70%, 100%(1:1), 141%, 200%, 400%
		<b>Copy Features</b>	Preset R/E Ratios by Area, Two-Sided, Density Adjustment, Original Type Selection, Interrupt Mode, Book to Two Pages, Two-sided Original, Job Build, N on 1, Add Cover, Insert Sheets, Different Size Originals, Page Numbering, Copy Set Numbering, Sharpness, Erase Frame, Secure Watermark, Print Date, Gutter, Print & Check, Negative/Positive, Repeat Images, Merge Job Blocks, Mirror Image, Store in Mail Box, Superimpose Image, Copy ID Card, Skip Blank Pages, Free Size Original, Color Mode, Reserved Copy, Copy Sample
		<b>Copy Resolution (dpi)</b>	Up to 999 copies
		<b>Multiple Copies</b>	Automatic or Manual (9 Levels)
		<b>Magnification</b>	Variable zoom: 25% to 400% (1% Increments) Preset reduction/enlargement: 25%, 50%, 70%, 100%(1:1), 141%, 200%, 400%
		<b>Copy Features</b>	Preset R/E Ratios by Area, Two-Sided, Density Adjustment, Original Type Selection, Interrupt Mode, Book to Two Pages, Two-sided Original, Job Build, N on 1, Add Cover, Insert Sheets, Different Size Originals, Page Numbering, Copy Set Numbering, Sharpness, Erase Frame, Secure Watermark, Print Date, Gutter, Print & Check, Negative/Positive, Repeat Images, Merge Job Blocks, Mirror Image, Store in Mail Box, Superimpose Image, Copy ID Card, Skip Blank Pages, Free Size Original, Color Mode, Reserved Copy, Copy Sample
		<b>Copy Resolution (dpi)</b>	Up to 999 copies
		<b>Multiple Copies</b>	Automatic or Manual (9 Levels)
		<b>Magnification</b>	Variable zoom: 25% to 400% (1% Increments) Preset reduction/enlargement: 25%, 50%, 70%, 100%(1:1), 141%, 200%, 400%
		<b>Copy Features</b>	Preset R/E Ratios by Area, Two-Sided, Density Adjustment, Original Type Selection, Interrupt Mode, Book to Two Pages, Two-sided Original, Job Build, N on 1, Add Cover, Insert Sheets, Different Size Originals, Page Numbering, Copy Set Numbering, Sharpness, Erase Frame, Secure Watermark, Print Date, Gutter, Print & Check, Negative/Positive, Repeat Images, Merge Job Blocks, Mirror Image, Store in Mail Box, Superimpose Image, Copy ID Card, Skip Blank Pages, Free Size Original, Color Mode, Reserved Copy, Copy Sample
		<b>Copy Resolution (dpi)</b>	Up to 999 copies
		<b>Multiple Copies</b>	Automatic or Manual (9 Levels)
		<b>Magnification</b>	Variable zoom: 25% to 400% (1% Increments) Preset reduction/enlargement: 25%, 50%, 70%, 100%(1:1), 141%, 200%, 400%
		<b>Copy Features</b>	Preset R/E Ratios by Area, Two-Sided, Density Adjustment, Original Type Selection, Interrupt Mode, Book to Two Pages, Two-sided Original, Job Build, N on 1, Add Cover, Insert Sheets, Different Size Originals, Page Numbering, Copy Set Numbering, Sharpness, Erase Frame, Secure Watermark, Print Date, Gutter, Print & Check, Negative/Positive, Repeat Images, Merge Job Blocks, Mirror Image, Store in Mail Box, Superimpose Image, Copy ID Card, Skip Blank Pages, Free Size Original, Color Mode, Reserved Copy, Copy Sample
		<b>Copy Resolution (dpi)</b>	Up to 999 copies
		<b>Multiple Copies</b>	Automatic or Manual (9 Levels)
		<b>Magnification</b>	Variable zoom: 25% to 400% (1% Increments) Preset reduction/enlargement: 25%, 50%, 70%, 100%(1:1), 141%, 200%, 400%
		<b>Copy Features</b>	Preset R/E Ratios by Area, Two-Sided, Density Adjustment, Original Type Selection, Interrupt Mode, Book to Two Pages, Two-sided Original, Job Build, N on 1, Add Cover, Insert Sheets, Different Size Originals, Page Numbering, Copy Set Numbering, Sharpness, Erase Frame, Secure Watermark, Print Date, Gutter, Print & Check, Negative/Positive, Repeat Images, Merge Job Blocks, Mirror Image, Store in Mail Box, Superimpose Image, Copy ID Card, Skip Blank Pages, Free Size Original, Color Mode, Reserved Copy, Copy Sample
		<b>Copy Resolution (dpi)</b>	Up to 999 copies
		<b>Multiple Copies</b>	Automatic or Manual (9 Levels)
		<b>Magnification</b>	Variable zoom: 25% to 400% (1% Increments) Preset reduction/enlargement: 25%, 50%, 70%, 100%(1:1), 141%, 200%, 400%
		<b>Copy Features</b>	Preset R/E Ratios by Area, Two-Sided, Density Adjustment, Original Type Selection, Interrupt Mode, Book to Two Pages, Two-sided Original, Job Build, N on 1, Add Cover, Insert Sheets, Different Size Originals, Page Numbering, Copy Set Numbering, Sharpness, Erase Frame, Secure Watermark, Print Date, Gutter, Print & Check, Negative/Positive, Repeat Images, Merge Job Blocks, Mirror Image, Store in Mail Box, Superimpose Image, Copy ID Card, Skip Blank Pages, Free Size Original, Color Mode, Reserved Copy, Copy Sample
		<b>Copy Resolution (dpi)</b>	Up to 999 copies
		<b>Multiple Copies</b>	Automatic or Manual (9 Levels)
		<b>Magnification</b>	Variable zoom: 25% to 400% (1% Increments) Preset reduction/enlargement: 25%, 50%, 70%, 100%(1:1), 141%, 200%, 400%
		<b>Copy Features</b>	Preset R/E Ratios by Area, Two-Sided, Density Adjustment, Original Type Selection, Interrupt Mode, Book to Two Pages, Two-sided Original, Job Build, N on 1, Add Cover, Insert Sheets, Different Size Originals, Page Numbering, Copy Set Numbering, Sharpness, Erase Frame, Secure Watermark, Print Date, Gutter, Print & Check, Negative/Positive, Repeat Images, Merge Job Blocks, Mirror Image, Store in Mail Box, Superimpose Image, Copy ID Card, Skip Blank Pages, Free Size Original, Color Mode, Reserved Copy, Copy Sample
		<b>Copy Resolution (dpi)</b>	Up to 999 copies
		<b>Multiple Copies</b>	Automatic or Manual (9 Levels)
		<b>Magnification</b>	Variable zoom: 25% to 400% (1% Increments) Preset reduction/enlargement: 25%, 50%, 70%, 100%(1:1), 141%, 200%, 400%
		<b>Copy Features</b>	Preset R/E Ratios by Area, Two-Sided, Density Adjustment, Original Type Selection, Interrupt Mode, Book to Two Pages, Two-sided Original, Job Build, N on 1, Add Cover, Insert Sheets, Different Size Originals, Page Numbering, Copy Set Numbering, Sharpness, Erase Frame, Secure Watermark, Print Date, Gutter, Print & Check, Negative/Positive, Repeat Images, Merge Job Blocks, Mirror Image, Store in Mail Box, Superimpose Image, Copy ID Card, Skip Blank Pages, Free Size Original, Color Mode, Reserved Copy, Copy Sample
		<b>Copy Resolution (dpi)</b>	Up to 999 copies
		<b>Multiple Copies</b>	Automatic or Manual (9 Levels)
		<b>Magnification</b>	Variable zoom: 25% to 400% (1% Increments) Preset reduction/enlargement: 25%, 50%, 70%, 100%(1:1), 141%, 200%, 400%
		<b>Copy Features</b>	Preset R/E Ratios by Area, Two-Sided, Density Adjustment, Original Type Selection, Interrupt Mode, Book to Two Pages, Two-sided Original, Job Build, N on 1, Add Cover, Insert Sheets, Different Size Originals, Page Numbering, Copy Set Numbering, Sharpness, Erase Frame, Secure Watermark, Print Date, Gutter, Print & Check, Negative/Positive, Repeat Images, Merge Job Blocks, Mirror Image, Store in Mail Box, Superimpose Image, Copy ID Card, Skip Blank Pages, Free Size Original, Color Mode, Reserved Copy, Copy Sample
		<b>Copy Resolution (dpi)</b>	Up to 999 copies
		<b>Multiple Copies</b>	Automatic or Manual (9 Levels)
		<b>Magnification</b>	Variable zoom: 25% to 400% (1% Increments) Preset reduction/enlargement: 25%, 50%, 70%, 100%(1:1), 141%, 200%, 400%
		<b>Copy Features</b>	Preset R/E Ratios by Area, Two-Sided, Density Adjustment, Original Type Selection, Interrupt Mode, Book to Two Pages, Two-sided Original, Job Build, N on 1, Add Cover, Insert Sheets, Different Size Originals, Page Numbering, Copy Set Numbering, Sharpness, Erase Frame, Secure Watermark, Print Date, Gutter, Print & Check, Negative/Positive, Repeat Images, Merge Job Blocks, Mirror Image, Store in Mail Box, Superimpose Image, Copy ID Card, Skip Blank Pages, Free Size Original, Color Mode, Reserved Copy, Copy Sample
		<b>Copy Resolution (dpi)</b>	Up to 999 copies
		<b>Multiple Copies</b>	Automatic or Manual (9 Levels)
		<b>Magnification</b>	Variable zoom: 25% to 400% (1% Increments) Preset reduction/enlargement: 25%, 50%, 70%, 100%(1:1), 1

# TECHNICAL SPECIFICATIONS

# imageRUNNER ADVANCE DX C5800 Series

<b>File Format</b>	TIFF, JPEG, PDF (Limited Color, Compact, Searchable, Apply policy, Optimize for Web, PDF/A-1b, Trace & Smooth, Encrypted, Device Signature, User Signature), XPS (Compact, Searchable, Device Signature, User Signature), Office Open XML (PowerPoint, Word)	<b>Power consumption</b>	Maximum: Approx. 2,000 W (iR-ADV DX C5870i) Approx. 1,800 W (iR-ADV DX C5860i/C5850i/C5840i) Copying (with DADF continuous scan): Approx. 943 W* Standby: Approx. 53.4 W* Sleep mode: Approx. 0.8 W* * Reference value: measured one unit ** 0.8 W is not available in all circumstances due to certain settings.
<b>Universal Send Features</b>	Original Type Selection, Two-sided Original, Book to Two Pages, Different-size Originals, Density Adjustment, Sharpness, Copy Ratio, Erase Frame, Job Build, Delayed Send, Preview, Job Done Notice, File Name, Subject/Message, Reply-to, E-mail Priority, TX Report, Original Content Orientation, Skip Blank Pages	<b>Noise levels (BW/CL)</b>	Typical Electricity Consumption (TEC)* : iR-ADV DX C5870i: 0.86 kWh iR-ADV DX C5860i: 0.71 kWh iR-ADV DX C5850i: 0.58 kWh iR-ADV DX C5840i: 0.46 kWh * As per USA Energy Star 3.0
<b>FAX SPECIFICATIONS</b>	(Optional)		Sound Power Level (LWA,m) Active (BW) (1-sided) iR-ADV DX C5870i: 66 dB*, Kv 3 dB* iR-ADV DX C5860i: 64 dB*, Kv 3 dB* iR-ADV DX C5850i: 62 dB*, Kv 3 dB* iR-ADV DX C5840i: 61 dB*, Kv 3 dB* *Reference value: measured only one unit with ISO7779, described with ISO9296 (2017)
<b>Maximum Number of Connection Lines</b>	2 (2nd line optional)		Sound Pressure (LpAm) Bystander's position: Active (BW/CL) (1-sided) iR-ADV DX C5870i: 52 dB*/52 dB* iR-ADV DX C5860i: 50 dB*/51 dB* iR-ADV DX C5850i: 48 dB*/49 dB* iR-ADV DX C5840i: 47 dB*/47 dB*
<b>Modem Speed</b>	Super G3: 33.6 kbps G3: 14.4 kbps	<b>Standards</b>	Stand-by iR-ADV DX C5870i/C5860i/C5850i: 23 dB* * Reference value: measured only one unit with ISO7779, described with ISO9296 (2017)
<b>Compression Method</b>	MH, MR, MMR, JBIG	<b>CONSUMABLES</b>	Blue Angel
<b>Resolution (dpi)</b>	400 x 400 (Ultra Fine), 200 x 400 (Super Fine), 200 x 200 (Fine), 200 x 100 (Normal)	<b>Toner Cartridges</b>	C-EXV 58 Toner BK/C/M/Y C-EXV 58L Toner C/M/Y
<b>Sending/Receiving Size</b>	Sending: A3, A4, A4R, A5*, A5R*, B4, B5*, B5R* Receiving: A3, B4, A4, A4R, A5R, B5, B5R *1 Sent as A4 *2 Sent as B4 short	<b>Toner Yield (Estimated Yield @5% coverage)</b>	C-EXV 58 Toner BK: 71,000 pages C-EXV 58 Toner C/M/Y: 60,000 pages C-EXV 58L Toner C/M/Y: 26,000 pages
<b>FAX memory</b>	Up to 30,000 pages (2,000 jobs)	<b>SOFTWARE AND PRINTER MANAGEMENT</b>	For detailed information please visit our website <a href="https://www.canon-europe.com/business/">https://www.canon-europe.com/business/</a>
<b>Speed dials</b>	Max. 200	<b>Tracking and reporting</b>	Universal Login Manager (ULM) uniFLOW Online Express*
<b>Group dials/destinations</b>	Max. 199 dials	<b>Remote management tools</b>	* For more information, please refer to <a href="#">uniFLOW Online Express</a> <a href="#">uniFLOW Online</a>
<b>Sequential broadcast</b>	Max. 256 addresses		iWEMC eMaintenance Content Delivery System Network ScanGear
<b>Memory backup</b>	Yes		Canon Driver Configuration Tool MEAP (Multifunction Embedded Application Platform) Kofax PowerPDF Advanced (Optional)
<b>Fax Features</b>	Sender's Name (TTI), Selecting the Telephone Line (when sending fax), Direct Send, Delayed Send, Preview, Job Done Notice, TX Report, Interrupt Transmission, Sequential Broadcasting, Password/Subaddress Sending, Confidential Mailbox, 2 on 1 Log		For full specifications & options, please visit the Canon website Optional on all models imagePASS-R1 (Embedded) 1200 x 1200, 600 x 600 Adobe PS3,PCL6 4GB (1x4GB) 500 GB SATA Intel Pentium G4400 (3.3GHz) FS400
<b>STORE SPECIFICATIONS</b>		<b>PAPER SUPPLY OPTIONS</b>	<b>Cassette Feeding Unit-AQ1</b> Paper Capacity: 2 x 550 sheets (80 gsm) Paper Type: Thin, Plain, Recycled, Color, Heavy, Bond, Transparency, Pre-punched, Letterhead Paper Size: A3, A4, A4R, A5, A5R, A6R, B4, B5, B5R Custom size: 98.0 x 148.0 mm to 304.8 x 457.2 mm  Paper Weight: 52 to 256 gsm Dimensions (W x D x H): 620 x 660 x 251 mm (attached to the main unit) Weight: Approx. 22 kg
<b>Mail Box (Number supported)</b>	100 User Inboxes, 1 Memory RX Inbox, 50 Confidential Fax Inboxes Maximum 10,000 Pages (2,000 jobs) Stored	<b>High Capacity Cassette Feeding Unit-C1</b>	Paper Capacity: 2,450 sheets (80 gsm) Paper Type: Thin, Plain, Recycled, Color, Heavy, Bond, Pre-punched, Letterhead Paper Size: A4 Paper Weight: 52 to 256 gsm Dimensions (W x D x H): 620 x 660 x 251 mm (attached to the main unit) Weight: Approx. 29 kg
<b>Advanced Space</b>	Communication Protocol: SMB or WebDAV Supported Client PC: Windows* 8.1/10 Concurrent Connections (Max.): SMB:64, WebDAV:3 Standard:16 GB (With option: max. 480GB)	<b>Paper Deck Unit-F1</b>	Paper Capacity: 2,700 sheets (80 gsm) Paper Type: Thin, Plain, Color, Recycled, Heavy, Pre-punched Paper Size: A4, B5 Paper Weight: 52 to 256 gsm Dimensions (W x D x H): 344 x 630 x 440 mm (attached to the main unit) Weight: Approx. 31 kg
<b>Advanced Space available disc space</b>	Authentication for Advanced Space Log-in, Sort Function, Printing a PDF File with a Password, imageWARE Secure Audit Manager Support, Search, File Preview, Authentication Management, Open to public, URI TX, Backup/Restore	<b>OUTPUT OPTIONS*</b>	1st Copy Tray Kit-A1
<b>Advanced Space Features:</b>			*Paper capacity may vary with different paper type/size. Capacity (with 80gsm paper): A4, A5, A5R, A6R, B5: 250 sheets SRA3, A3, A4R, B4, B5R: 100 sheets Paper Weight: 52 to 300 gsm
<b>SECURITY SPECIFICATIONS</b>			
<b>Authentication and Access Control (Activation is required)</b>	User Authentication (Picture Login, Picture and PIN Login, Card Login*, Username and Password Login, Function Level Login, Mobile Login), Department ID Authentication (Department ID and PIN Login, Function Level Login), uniFLOW Online Express (PIN Login, Picture Login, Picture and PIN Login, Card Login*, Card and PIN Login, Username and Password Login, Department ID and PIN Login, Function Level Login), Access Management System (Access Control) * Card readers are optional, please refer to Hardware Accessories		
<b>Document Security</b>	Print Security (Secure Print, Encrypted Secure Print, Forced Hold Printing, uniFLOW Secure Print*), Receive Data Security (Confidential Fax Inbox Forwarding Received Documents Automatically), Scan Security (Encrypted PDF, Device Signature PDF/XPS, User Signature PDF/XPS, Adobe LiveCycle* Rights Management ES2.5 Integration), BOX Security (Mail Box Password Protected, Advanced Space Access Control), Send Data Security (Setting for requesting password input per transmission, Restricted E-mail/File send functions, Confirming FAX number, Allow/Restrict Fax Driver Transmissions, Allow/Restrict Sending from History, S/MIME Support), Document Tracking (Secure Watermark) *1 Requires uniFLOW Online / uniFLOW		
<b>Network Security</b>	TLS 1.3, IPsec, IEEE802.1X authentication, SNMP V3.0, Firewall Functionality (IP/MAC Address Filtering), Dual Network Support (Wired LAN/Wireless LAN, Wired LAN/Wired LAN), Disabling Unused Functions (Enabling/Disabling Protocols/Applications, Enabling/Disabling Remote UI, Enabling/Disabling USB Interface), G3 FAX separation from LAN, USB Port separation from LAN, Prohibit the execution of files stored in Advanced Box in the MFP, Scan and Send -Virus Concerns for E-mail Reception		
<b>Device Security</b>	Protecting SSD Data (SSD Data Encryption (FIPS140-2 Validated), SSD Lock, Standard SSD Initialize, Trusted Platform Module (TPM 2.0), Job Log Conceal Function, Protecting MFD Software Integrity, Checking MFD Software Integrity (Verify System at Startup, Runtime Intrusion Detection), HCD-PP* * Certification will follow post launch of this Series		
<b>Device Management and Auditing</b>	Administrator Password, Digital Certificate And Key Management, Audit Log, Cooperating with External Security Audit System (Security Information and Event Management), Image Data Logging, Security Policy Setting		
<b>ENVIRONMENTAL SPECIFICATIONS</b>			
<b>Operating Environment</b>	Temperature: 10 to 30 °C Humidity: 20 to 80 % RH (Relative Humidity)		
<b>Power source</b>	220-240 V, 50/60 Hz, 6 A		



# TECHNICAL SPECIFICATIONS

# imageRUNNER ADVANCE DX C5800 Series

## Inner 2way Tray-M1

Tray Capacity (with 80 gsm paper)  
Upper tray: A4, A5, A5R, A6R, B5: 100 sheets  
SRA3, A3, A4R, B4, B5R: 50 sheets  
Lower tray: A4, A5, A5R, A6R, B5: 100 sheets  
SRA3, A3, A4R, B4, B5R: 100 sheets

Paper Weight: 52 to 300 gsm  
Dimensions (W x D x H): 428 x 405 x 88 mm  
Weight: Approx. 0.7 kg

## 3rd Copy Tray Kit-A1

Capacity (with 80gsm paper):  
A4, A5R, B5: 100 sheets  
A3, A4R, B4, B5R: 75 sheets  
Paper Weight: 52 to 300 gsm  
Dimensions (W x D x H): 442 x 373 x 176 mm  
(attached to the main unit, when the extension tray is extended)  
Weight: 0.5 kg

## Inner Finisher-L1

(Not supported for iR-ADV DX C5870i)

Tray Capacity (with 80gsm paper):  
Upper Tray: SRA3, A3, A4, A4R, A5, A5R, A6R, B4, B5, B5R: approx 45 sheets  
Lower Tray: A4, A5, A5R, B5: approx. 500 sheets,  
SRA3, A3, A4R, B4, B5R: 250 sheets,  
A6R: 30 sheets  
Envelope: 10 sheets

Paper Weight: 52 to 300 gsm  
Staple Position: Corner, Double  
Staple Capacity: (52 to 90 gsm paper)  
A4, B5: 50 sheets  
A4R: 40 sheets  
A3, B4: 30 sheets  
Eco Staple\*:

A4, B5: 10 sheets (52 to 64 gsm)  
8 sheets (65 to 81.4 gsm)  
6 sheets (82 to 105 gsm)

A3, B4: 5 sheets (52 to 64 gsm)  
4 sheets (65 to 81.4 gsm)  
3 sheets (82 to 105 gsm)

Staple On Demand: 40 sheets (80 gsm)  
Dimensions (W x D x H): 743 x 525 x 225 mm  
(attached to the main unit, when the extension tray is extended)  
Weight: Approx. 9.1 kg

\* Large size media A3/B4 support will be available from March 2021 when an update to the firmware is applied:

A3\*, B4\*: 10 sheets (52 to 64 gsm)  
8 sheets (65 to 81.4 gsm)  
6 sheets (82 to 105 gsm)

## Staple Finisher-AB1

(Requires Buffer Pass Unit-P1)  
Tray Capacity (with 80gsm paper):  
Upper Tray: A4, A5, A5R, A6R, B5: approx. 250 sheets,  
SRA3, A3, A4R, B4, B5R: approx. 125 sheets

Lower Tray: A4, A5, A5R, B5: 3,000 sheets,  
SRA3, A3, A4R, B4, B5R: 1,500 sheets,  
A6R: 250 sheets  
Envelopes: Monarch: 30 sheets, COM10 No.10,  
DL, ISO-C5: 100 sheets

Paper Weight:  
Upper Tray 52 to 256 gsm,  
Lower Tray 52 to 300 gsm  
Staple Position: Corner, Double  
Staple Capacity: (52 to 90 gsm)

A4, B5: 50 sheets  
A4R: 40 sheets  
A3, B4: 30 sheets  
Eco Staple\*:

A4: 10 sheets (52 to 64 gsm)  
8 sheets (65 to 81.4 gsm)  
6 sheets (82 to 105 gsm)

A3: 5 sheets (52 to 64 gsm)  
4 sheets (65 to 81.4 gsm)  
3 sheets (82 to 105 gsm)

Staple On Demand: 50 sheets (52 to 90 gsm)  
Dimensions (W x D x H): 637 x 623 x 1,142 mm  
(when the extension tray is extended)  
Weight: Approx. 31 kg

\* Large size media A3 support will be available from March 2021 when an update to the firmware is applied

A3\*: 10 sheets (52 to 64 gsm)  
8 sheets (65 to 81.4 gsm)  
6 sheets (82 to 105 gsm)

## Booklet Finisher-AB1

(Requires Buffer Pass Unit-P1)  
(Includes the above Staple Finisher-AB1 basic staple specifications.)  
Saddle Stitch paper size: A3, A4R, B4  
Saddle Stitch Staple Capacity: 20 sheets x 10 sets  
(52 to 81.4 gsm) (including 1 cover sheet 52 to 256 gsm)  
Non Staple Folded Bunch Capacity: up to 3 sheets (52 to 105 gsm)  
Dimensions (W x D x H): 637 x 623 x 1,142 mm  
(when the extension tray is extended)  
Weight: Approx. 57 kg

## Inner 2/4 Hole Puncher-D1

(Not supported for iR-ADV DX C5870i)

(Requires the Inner Finisher-L1)  
Two or Four Holes  
Acceptable Punch Paper Weight: 52 to 300 gsm  
Acceptable Punch Paper Size:

Two holes: A3, A4, A4R, A5, B4, B5, B5R  
Four holes: A3, A4

## Inner 4 Hole Puncher-D1

(Not supported for iR-ADV DX C5870i)

(Requires the Inner Finisher-L1)  
Four Holes  
Acceptable Punch Paper Weight: 52 to 300 gsm  
Acceptable Punch Paper Size:

Four holes: A3, A4, A4R, A5, B4, B5, B5R

## 2/4 Hole Puncher Unit-A1

(Requires either the Staple Finisher-AB1 or Booklet Finisher-AB1)  
Two or Four Holes  
Acceptable Punch Paper Weight: 52 to 300 gsm  
Acceptable Punch Paper Size:

Two holes: A3, A4, A4R, A5, B4, B5, B5R  
Four holes: A3, A4

## 4 Hole Puncher Unit-A1

(Requires either the Staple Finisher-AB1 or Booklet Finisher-AB1)  
Four Holes  
Acceptable Punch Paper Weight: 52 to 300 gsm  
Acceptable Punch Paper Size:

Four holes: A3, A4, A4R, A5, B4, B5, B5R

## HARDWARE ACCESSORIES

### Card Readers

Various card readers available e.g. MiCard Plus.  
Please contact local Canon Office for more details.

Copy Card Reader Attachment-B7  
IC Card Reader Box for Numeric Keypad-A1  
Copy Card Reader-F1

### Others

Printer Cover-M2  
Tab Feeding Attachment-F1  
Buffer Pass Unit-P1  
Utility Tray-B1  
Numeric Keypad-A2

## SECURITY OPTIONS

### Data Security

256GB SSD-A1  
1TB SSD-A1  
Memory Mirroring Kit-A1

## SYSTEM AND CONTROLLER OPTIONS

Print Accessories  
Barcode Printing  
EFI-Fiery Based Controller  
EFI-Fiery Based Controller Options

## System Accessories

PCL International Font Set-A1  
Barcode Printing Kit-D1  
imagePASS-R1  
Hot Folders License  
Fiery Compose  
Fiery Impose  
Fiery Impose and Compose  
NFC Kit-E2  
Serial Interface Kit-K3  
Copy Control Interface Kit-A1  
Connection Kit-A3 for Bluetooth LE  
Super G3 FAX Board-AX1  
Super G3 2nd Line Fax Board-AX1  
Remote Fax Kit-A1  
IP FAX Expansion Kit-B1

## Fax Accessories

## OTHER OPTIONS

### Accessibility Accessories

ADF Access Handle-A1  
Voice Guidance Kit-G1  
Voice Operation Kit-D1  
Staple Cartridge-Y1 (2 x 2,000pcs)\*  
Staple-P1 (2 x 5,000pcs)

\*For Booklet Finisher only

## Consumables

## Software & Solutions



## Certifications and compatibility



Canon Ireland  
3006 Lake Drive  
Citywest, Saggart  
Co. Dublin, Ireland  
Telephone No: 01 2052400  
Facsimile No: 01 2052525  
canon.ie

Canon (UK) Ltd  
5 The Square  
Stockley Park  
Uxbridge  
UB11 1ET  
Tel: 01895 648 000  
www.canon.co.uk

Canon Inc.  
canon.com  
Canon Europe  
canon-europe.com  
English edition  
© Canon Europa N.V., 2020

